

WOODRISE BORDEAUX 2017

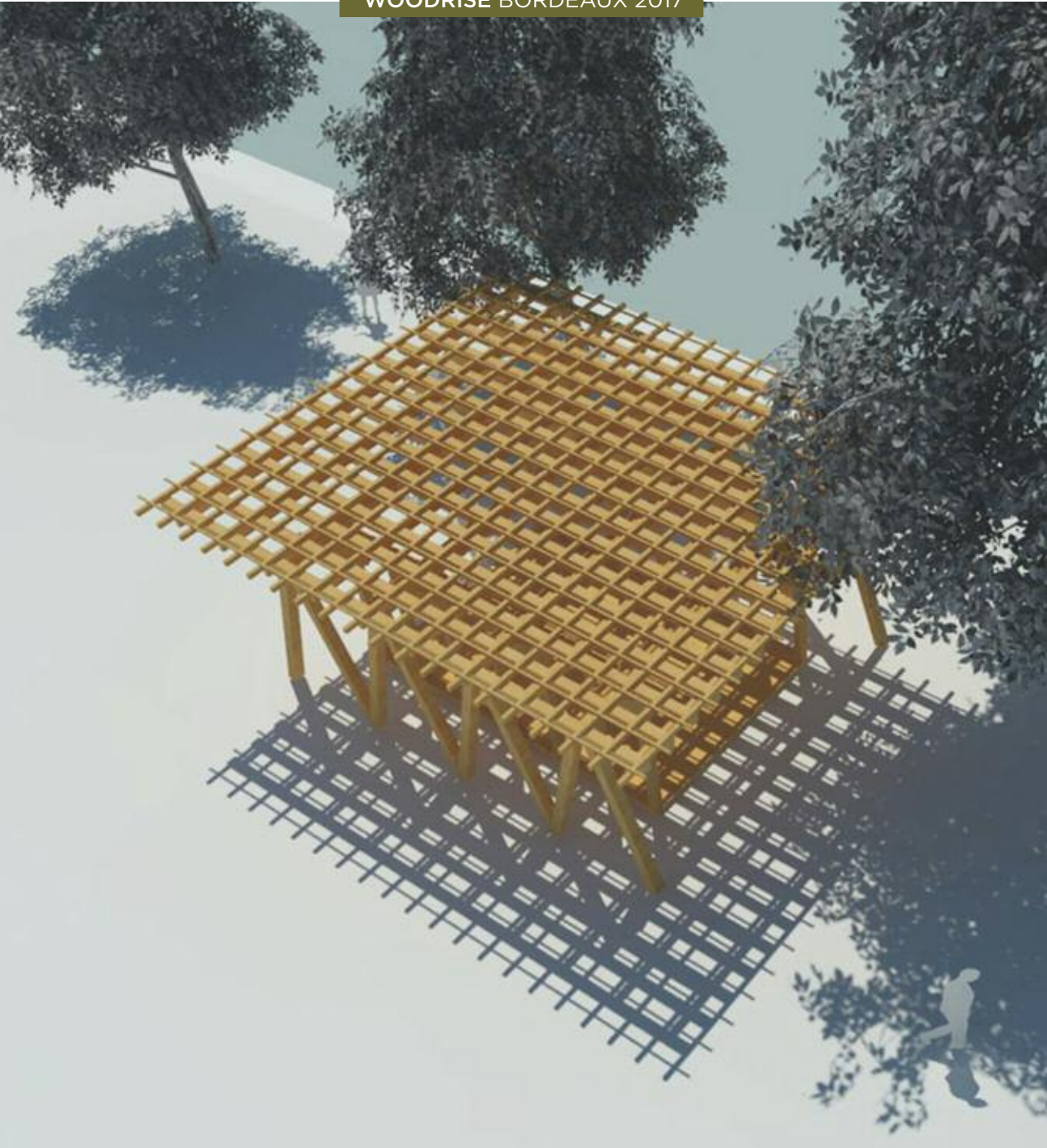

Y FOREST  
ARIUS

THE INTELLIGENCE OF WOOD



The logo\_

A symbol of emancipated construction, it recalls the three-pronged organisation of Forestarius, which brings together the architect, the builder and the developer.

“A fence only stands firm when supported by three stakes”

*(Chinese proverb)*

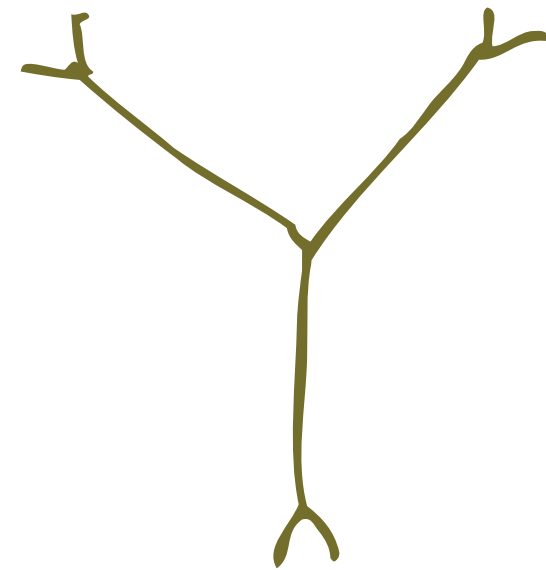

Wood is fundamental to our approach.

This universal and timeless raw material has always held a special fascination for humankind, which used it to fashion its first shelters.

Central to the challenges raised by the ecological transition and sustainable communities, wood sowed the seeds of an idea - the idea to take a stand in a market disadvantaged by its dominant organisational and intellectual models.

**FORESTARIUS THE INTELLIGENCE OF WOOD**

This booklet features a selection of programmes created and developed for clients who have already placed their trust in us: head office of the Caisse d'Epargne Bourgogne Franche-Comté | Silo, dismountable car park | Ecopolis, office building, AMI ADIVbois | Motel

## Forestarius believes in the intelligence of wood.

Wood that adapts to each programme and any dimension, based on the guiding principle of "the right material in the right place."

Wood that benefits from European advances and lends itself to a wider range of construction uses.

Wood as a virtuous material that promotes the sustainable use of resources and consumption adapted to local environments.

Wood that nurtures short supply chains as a major source of local prosperity and employment.

Wood that is accessible to projects of all kinds, whatever their final form.

Wood that is put to optimal use, by combining innovation, responsibility and efficiency.

Born from a desire to share its free and distinctive vision, and determined to channel its energy into serving local communities and their actors, Forestarius is driven by a partnership model that brings together operators in the wood construction sector to offer a global constructive solution, from investment to sales to the resource and its transformation.

### WE CULTIVATE

#### THE FOLLOWING VALUES:

EXEMPLARITY

INNOVATION

ACCESSIBILITY

RESPONSIBILITY

FREEDOM

## Forestarius - ambition through partnership:

raising the standards of wood construction even higher



Our projects are developed on multiple scales and their success depends on the collaborative efforts of all stakeholders involved. The success of Forestarius is built on its ability to think outside the box when managing complex operations, in order to improve their environmental, economic and social performance.

the stand\_  
A wood construction, the stand embodies the Forestarius approach and complies with technical trade-show standards. Constructed around the repetition of a modular element, the 6 x 8 batten, it's an expression of our philosophy. It was designed to highlight our projects and to promote sharing and exchange.



## HEAD OFFICE OF THE CAISSE D'ÉPARGNE BOURGOGNE FRANCHE-COMTÉ

Parc Valmy, Dijon

As part of its business plan to speed up its transformation, the Caisse d'Épargne Bourgogne Franche-Comté commissioned a new head office for the Dijon metropolitan area, in Valmy business park. The selected architectural solution needs to raise the bank's visibility as a major player in the region using ecological and sustainable materials while limiting design and operating costs.

*To design this building, which is restrained and understated but also a symbol of wood construction, in conjunction with Jean-Marc Weill (C&E), and with the support of Professor Wolfgang Winter, a leading figure in the field, we opted for a "commonplace" construction model - commonplace in its construction method and assembly, and in the reasoning behind its use of materials. The proportions and structural system reflect the building's purpose with a standard 270 frame.*

Exposed across the entirety of the building's envelope, the wood structure is expressed in cross bracing. A bolted glass envelope produces a double-skin effect for greater thermal comfort and protection for the wood. The building has an L-shaped movement, and a wooden silo car park built alongside it.



Located in Dijon, this is the largest wooden tertiary and service ensemble in France, and is composed of the head office of CEBFC and a 557-space car park open to the public with beam-column structures.



**COMPLETION**  
end 2019

**SURFACE AREA**  
9,500 sq.m.

**BUDGET**  
€26 million

**CLIENT**  
SCCV  
Tertiaire Valmy

**ARCHITECT**  
GRAAM



**COMPLETION**  
september 2018

557 spaces  
(200 spaces for the  
Caisse d'Epargne  
Bourgogne  
Franche-Comté)

**BUDGET**  
€8.5 million

**CLIENT**  
LCDP

**ARCHITECT**  
GRAMM

## SILO SHARED CAR PARK

Parc Valmy, Dijon

Meeting the parking needs of an expanding business park, the Silo is based on a dismantlable concept applied to a virtuous construction model. Since the transition to the sustainable city is a step-by-step process, the dismantlable car park is an intermediary building that promotes the adoption of an ecological approach by users without denying the current reality.

*The idea for a wooden car park that adapts to the development of the urban space was an obvious one, reflecting as it does our collective awareness that cities, urban areas, architecture and materials need to correlate with their environment. Where concrete was once king, wood offers a totally different vision of parking.*



**The first  
dismountable  
wooden car park  
in France**



The wooden silo has a short construction time - around four months. Built using wood beam-columns, the primary structure sits on a prefabricated concrete slab that remains in place. The ventilation requirements are met by two opposing façades open to the wind.



**COMPLETION**  
end 2019

R+6

**SURFACE AREA**  
2,267 sq.m

**BUDGET**  
€4.5 million

**CLIENT**  
SEM

**ARCHITECT**  
GRAAM

## ECOPOLIS OFFICE BUILDING

ZAC Heudelet 26, Dijon



**Winner**  
of the AMI  
ADIVbois

A new landmark in the Heudelet 26 eco-district, Ecopolis is one of 24 sites to be presented with an award following a call for proposals by ADIVbois, the French association for the development of wood buildings. This is the most ambitious call for projects ever launched by a country for high-rise wood buildings.

*We approached the challenges raised by the construction of a high wood building as an opportunity to demonstrate its advantages in terms of speed, accessibility and sustainability. The building is composed of two volumes and a central core serving as an access point for other spaces. The open-plan layout, which maximises the use of the modular design, has been applied on either side of the core. The open-work design lets light flood in and transforms the building into an outstanding landmark.*



The two office volumes have completely different compositions:

the north façade overlooking the central garden is quiet and open with a shelf on each floor to serve as protection and as a planted medium; the south façade features regular vertical slats to offer views over the landscape and to shelter the building from the heat.

In the centre, the bracing core, housing the stairways and sanitary facilities, bears the load of the floors.



**COMPLETION**  
first quarter  
2018

**SURFACE AREA**  
88 structures with a  
surface area of 27 sq.m.

**CLIENT**  
LCDP

**ARCHITECT**  
GRAM

## MOTEL

### Monéteaux (89)

The brief was to design Motel-type structures for a national hotel chain. Fully accessible to people with reduced mobility, and compliant with technical norms in this field, all of the structures will be produced in a factory and delivered pre-assembled to the site.

This commission requires the use of an industrial process to which wood has proved to be particularly well-adapted in terms of speed of production, weight and solidity, which allow for the transport of the structures.



**Economical  
and sustainable**

*Since the immediate urban surroundings are tertiary and commercial in nature, the programme contrasts with the surrounding warehouses based on a landscaped approach and the integration of modular structures. Each bungalow will have its own parking space giving access to accommodation via a pedestrian pathway.*

From the woodwork to the bathroom to the interior finishes (excluding the foundations), every element is prefabricated in the workshop. The bungalows will be fitted with horizontal larch cladding with a natural wood stain, and the reception building will feature the same cladding with ochre-red shell-marl paint. The wood is sourced from a short supply chain.



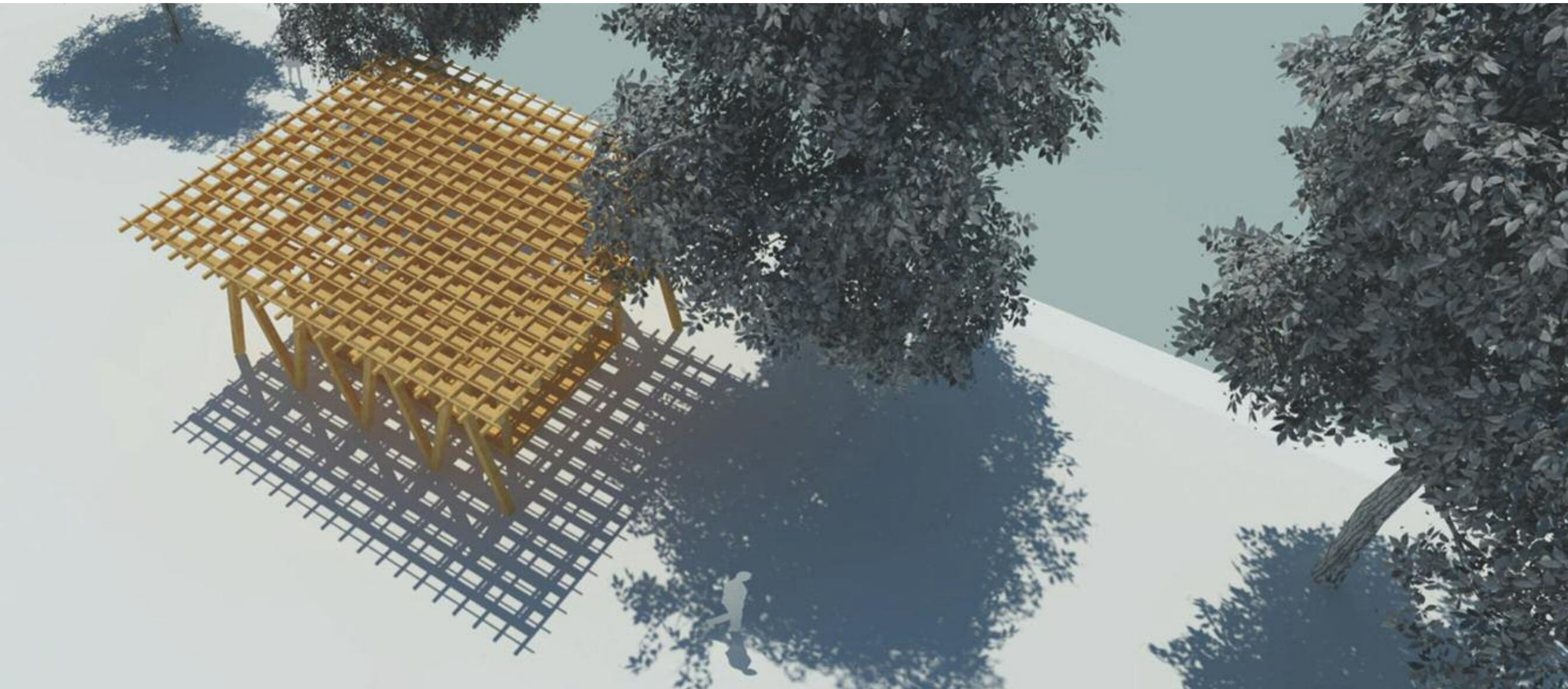

## THE WOODSTOCK PAVILION

like a stock of wood

This pavilion offers a history of construction - our history. Since height no longer places any particular limits on wood buildings, we decided to go back to basics - to the resource itself. And what could be simpler than a model using the most common frame section dimensions? When we drew up our plans, our intention was not to create a masterpiece or a traditional framework. By providing a descriptive exploded view, the pavilion explores the possibilities of wood, and compares European tools with their Far Eastern counterparts, showcases our jointing and demonstrates how wood is transformed by construction.

*The roof is formed by the stacking of different sections which, although flat, provide an insight into our king-post truss. The gallery gives visitors the impression of walking in a wall. Rather than a single section, the wall is separated into the outer bracing wall, which bears the wind load, and an inner wall that bears the roof load. This in-between design opens up new avenues for reflection, imagination and inspiration. It is a door, a passageway, a threshold, an enclosure, a cover, and more.*



---

**THE WOODSTOCK PAVILION**  
is being presented for the first time  
at the Woodrise 2017 exhibition,  
during the Agora biennale of architecture,  
planning and design in Bordeaux.

---



